

# Samsung Galaxy Tab™ Software Upgrade



## Overview

To help you with the mandatory system update for your Samsung Galaxy Tab, this page contains the following information:

- System Update Instructions
- System Update while you are Roaming

Here are a few facts to keep in mind:

- Software update size - 69.7MB
- Estimated software download time – approximately 7-10 minutes
- Estimated software update time – approximately 2-5 minutes

## System Update Instructions

You will be notified that a system update is available on your device.

1. Press "**Install now**" and your device will power off and back on and the installation process will begin.

**Note:** If you choose "**Install later**" this will delay installation and you will be taken back to the home screen. The system update message will appear every 30 minutes until you install the update.

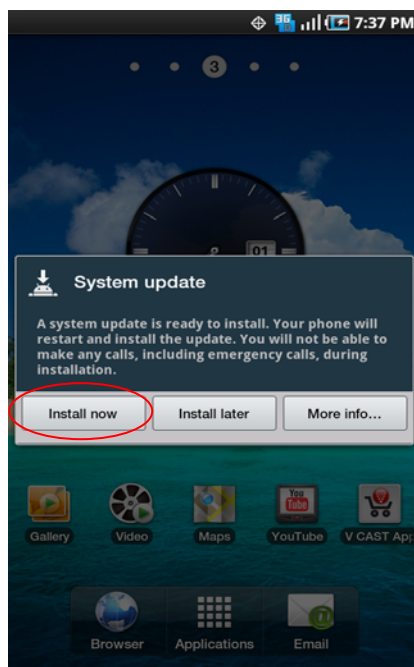

# Samsung Galaxy Tab™ Software Upgrade



2. If you press "**More Info...**" you will receive more information regarding the system update on your device.

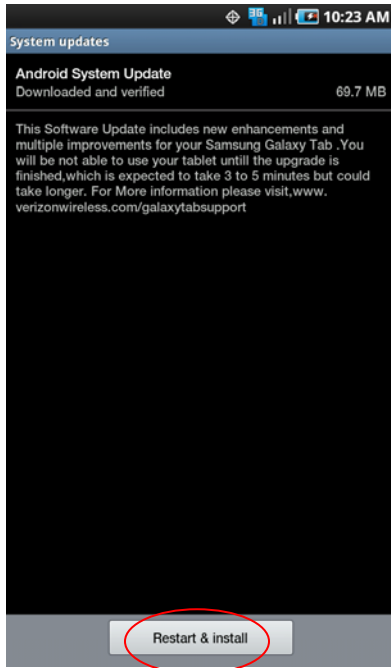

3. After you've received first notification of the system update, you can manually initiate by going to "**Home**" > "**Applications**" > "**Settings**" > "**About Device**" > "**System updates**". Press "**Restart & install**". Your device will power off and back on and the installation process will begin.
4. The update has begun once your device powers off and back on and you see the following screen:

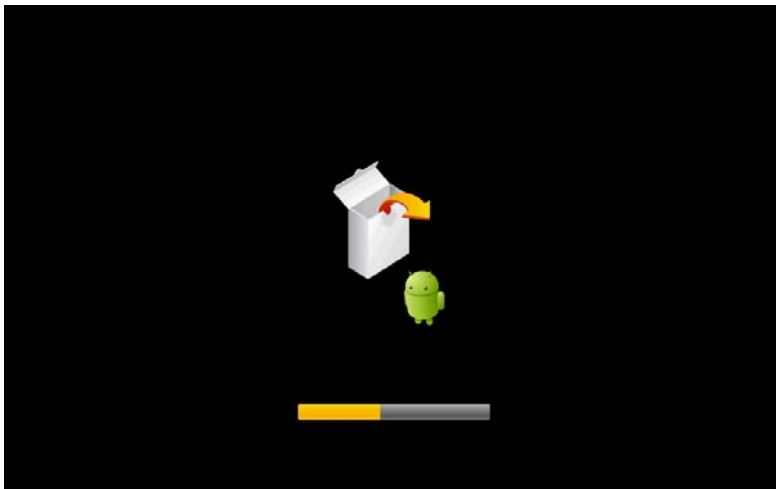

# Samsung Galaxy Tab™ Software Upgrade



## System Update while you are Roaming

---

1. If you are roaming you will not receive a system update notice. You will need to enable Wi-Fi and wait for the update notice to appear or as mentioned above you can manually update by going to "**Home**" > "**Application**" > "**Settings**" > "**About device**" > "**System updates**".
2. To enable Wi-Fi go to "**Settings**" > "**Wireless & networks**". Tap "**Wi-Fi**" to enable.
3. To connect, to an available "**Wi-Fi network**" select "**Wi-Fi settings**" and select an available an Wi-Fi network or manually add a Wi-Fi network that has had security settings established.

If the system update fails to install, you will get an error screen. However, this only means the software did not install properly. The device will power back on with original software and will prompt you once again to install the system update.

If the update fails again, please visit [www.verizonwireless.com/contactus](http://www.verizonwireless.com/contactus) .